



## Fertilizer Applicator Bar



Unit: Elxir 66, s/n 1004  
Approximate Acres: minimal  
Special Sale Price \$69,000  
Location: Conception Junction, MO

The Elxir66 is a heavy-duty 5-Section commercial fertilizer applicator from Farmada. This unit is a 19 row 30" row spacing and is designed for custom applicators or large farmers. This bar is intended to accommodate all types of farming practices from no-till to hill country with terraces and contours to maximize the performance based on local conditions and preferences.

### ➤ Strength and Accuracy

The Ladder-style frame with 6"x6" heavy tubing and large 66" spacing front to back was created to allow large in-line tires to be placed inside the frame. This offset provides superb row unit stagger for improved residue flow-through. A tractor specific one-time adjustment allows the operator to set the frame height. A single-point depth hydraulic control then enables the operator to adjust the working depth.

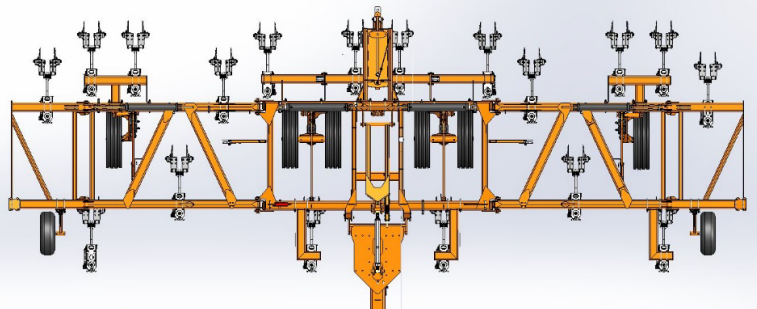

### ➤ Hybrid oscillating axles

The hybrid oscillating axle creates a field performance comparable to tandems in that the axles will independently adapt to the ground contour. By making them in-line and with large tires, the bar outperforms tandems when going over erosion washouts. This style provides more stable transport during road transport while spreading the machine weight evenly over the tires on crowned roads to reduce premature tire wear.

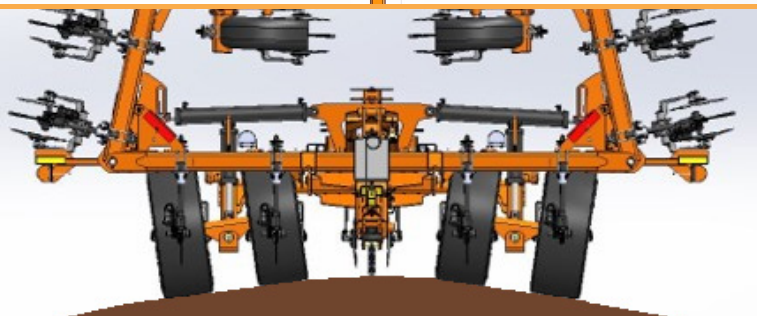

### ➤ Ground Contour Following Flex

The frames of the Elxir66 19 row 30" version can flex down 80" and flex up 87". This is accomplished by enabling a 40 degree combined vertical travel of the wings closest to the center section, and a 25 degree vertical movement of the second and second to last sections.

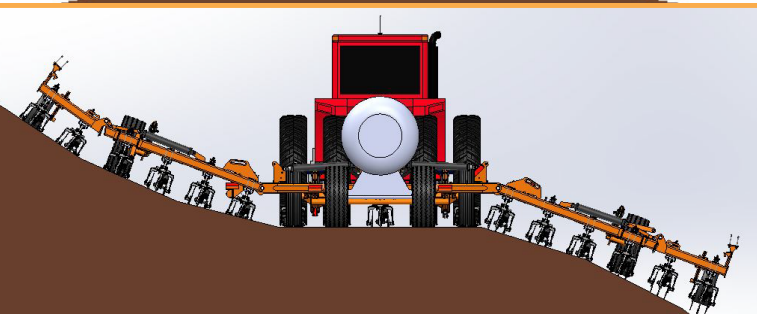

### ➤ Rear Trailer Hitch

The rear hitch extends 28" and at that point it can swing a total of 52" left to right. This simplifies backing up and connecting of the tank to the toolbar. Single and double break-away coupler arms are available, and the rear hitch light kit is standard.

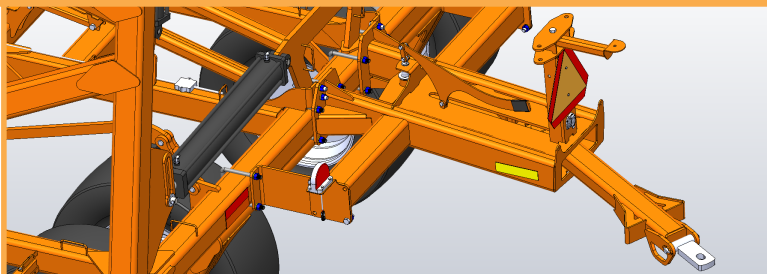

### ➤ Maintenance Free Frame

The entire Elxir frame has zero grease zerks for reduced maintenance. The pivot points on the frame feature self-lubricating, high wear resistant, and maintenance free bushings.

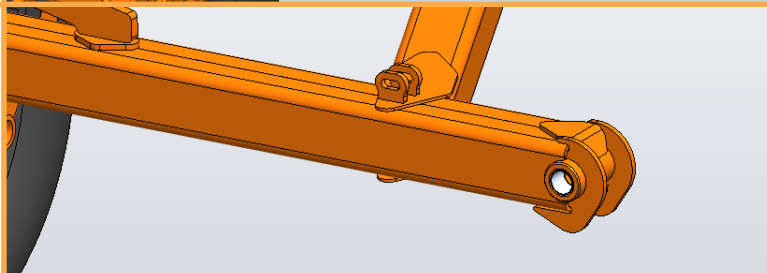

### ➤ Available Row Unit Styles

**Split Mount Style row units** - The coulter and shank are mounted in-line to a separate frame element on the ladder frame. This extra distance between coulter and shank lets the residue cut by the coulter settle before the shank follows the coulter furrow.

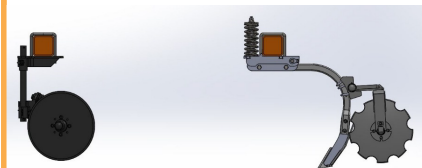

Unit Specifications	Model - Elxir 66
Number of Rows/Spacing	19 Row, 30"
Number of Sections	5
Min. HP Requirement	200-270 HP
Transport Clearance	10-3/4"
Working Width	47'-6"
Transport Height	13'-6"
Transport Width	18'-4"
Transport Length	19'-0"
Transport Tires	4 ea. 385/65R22.5
Wing Tires	2 ea. 385/65R22.5
Wing Gauge Wheels	2 ea. 11L-14
Front to Rear Frame Stagger	66"
Frame Tube Size	6" X 6"
Standard Rear Hitch	Extends 28"/Swings 52"
Rear Hitch Light Kit	Standard
Depth Control	Single Point Adjustment

Unit Specifications	Model - Elxir 66
Hitch	CAT 3 or CAT 4 Drawbar
Working Depth	8" to 12"
Downflex - Inside Wing	20 ° - 41"
Upflex - Inside Wing	15 ° - 46"
Downflex -Total	80"
Upflex - Outside Wing	15 ° - 46"
Hydraulic Requirements	2 valves
Coulter Size	20"
Cooler	Raven Vortex 1-1/2"
Controller	Ag Leader non ISO
Knives	Shield K-2T
Shanks	1-1/4" Flat Bent
Vapor Tubes	4 ea. 3/4"
# of Control Sections	5
Sealers	18" Notched
Location	Conception Junction, MO

**FARMADA**  
Ground-breaking farm implements  
for sustainable profits

PO Box 365  
107 South Center St.  
Assaria, KS 67416

Phone: 1-785-493-4962  
Email: [info@farmada.net](mailto:info@farmada.net)  
Web: [www.farmada.net](http://www.farmada.net)

Dealer Info: