



Fertilizer Applicator Bar



The Elxir66 is a heavy-duty 5-Section commercial fertilizer applicator from Farmada. Available in sizes from 16-21 rows at 30" row spacing, it was designed for custom applicators or large farmers. This bar is intended to accommodate all types of farming practices from no-till to hill country with terraces and contours to maximize the performance based on local conditions and preferences.

➤ Strength and Accuracy

The Ladder-style frame with 6"x6" heavy tubing and large 66" spacing front to back was created to allow large in-line tires to be placed inside the frame. This offset provides superb row unit stagger for improved residue flow-through. A tractor specific one-time adjustment allows the operator to set the frame height. A single-point depth hydraulic control then enables the operator to adjust the working depth.

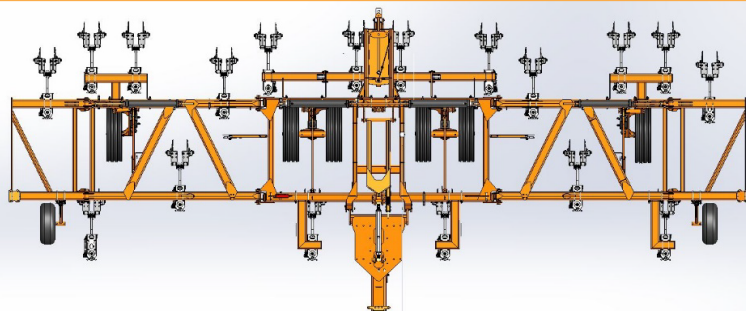

➤ Hybrid oscillating axles

The hybrid oscillating axle creates a field performance comparable to tandems in that the axles will independently adapt to the ground contour. By making them in-line and with large tires, the bar outperforms tandems when going over erosion washouts. This style provides more stable transport during road transport while spreading the machine weight evenly over the tires on crowned roads to reduce premature tire wear.

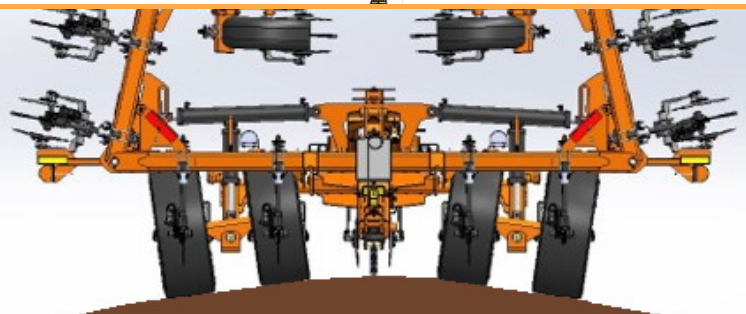

➤ Ground Contour Following Flex

The frames of the Elxir66 can flex down 51" on the 16-row and 77" on the 21-row bar. They can flex up 62" on the 16-row and 105" on a 21-row unit. This is accomplished by enabling a 40 degree combined vertical travel of the wings closest to the center section, and a 25 degree vertical movement of the second and second to last sections.

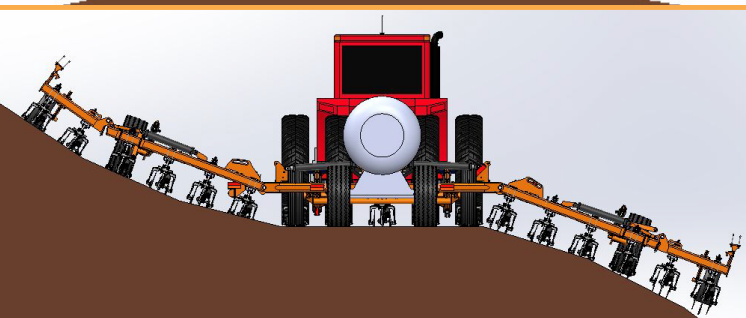

➤ Rear Trailer Hitch

The rear hitch extends 28" and at that point it can swing a total of 52" left to right. This simplifies backing up and connecting of the tank to the toolbar. Single and double break-away coupler arms are available, and the rear hitch light kit is standard.

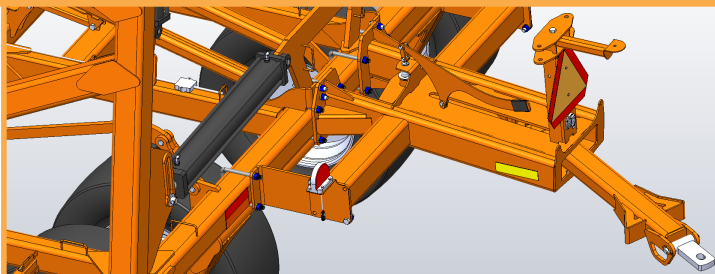

➤ Maintenance Free Frame

The entire Elxir frame has zero grease zerks for reduced maintenance. The pivot points on the frame feature self-lubricating, high wear resistant, and maintenance free bushings.

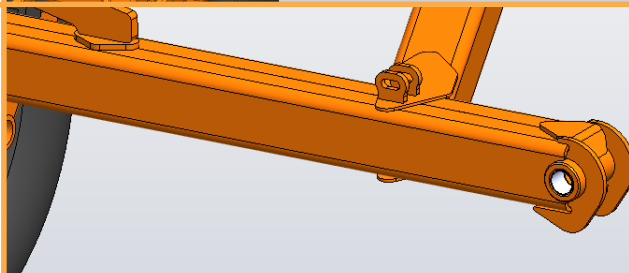

➤ Available Row Unit Styles

Coulter-Shank Style (CS) row units - The coulter and shank are mounted to the same 6"x6" frame member. Stagger to achieve residue flow through is done by mounting them on various locations on the ladder frame.

Split Mount Style row units - The coulter and shank are mounted in-line to a separate frame element on the ladder frame. This extra distance between coulter and shank lets the residue cut by the coulter settle before the shank follows the coulter furrow.

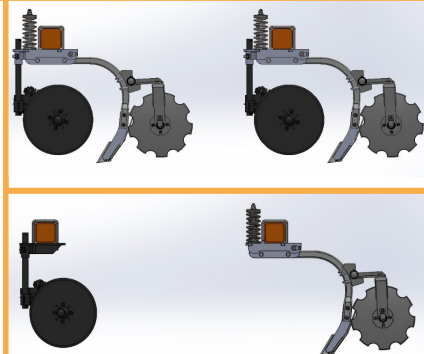

| Specifications | Model - Elxir 66 | Specifications | Model - Elxir 66 |
|------------------------|---|-----------------------------|--------------------------------|
| Number of Rows/Spacing | 16, 17, 18, 19, 20, 21 Row, 30" | Hitch | CAT 3 or CAT 4 Drawbar |
| Number of Sections | 5 | Working Depth | 8" to 12" |
| HP Requirement | 25 to 30 Drawbar HP/Shank | Downflex - Inside Wing | 20 ° - 36" to 41" |
| Transport Clearance | 10-3/4" | Upflex - Inside Wing | 20 ° - 36" to 41" |
| Working Width | 40' to 52'-6" | Downflex - Outside Wing | 0 ° (downflexes w/inside wing) |
| Transport Height | 13'-6" | Upflex - Outside Wing | 15 ° - 21" to 69" |
| Transport Width | 19'-0" | Front to Rear Frame Stagger | 66" |
| Transport Length | 24'-0" | Frame Tube Size | 6" X 6" |
| Transport Tires | 4 ea. 385/65R22.5 | Standard Rear Hitch | Extends 28"/Swings 52" |
| Wing Tires | 2 ea. 385/65R22.5 or 2 ea. 295/75R22.5 | Rear Hitch Light Kit | Standard |
| Wing Gauge Wheels | 2 ea. 11L-14 | Depth Control | Single Point Adjustment |



PO Box 365
107 South Center St.
Assaria, KS 67416

Phone: 1-785-493-4962
Email: info@farmada.net
Web: www.farmada.net

Dealer Info: